

PATH OF TRAVEL STATEMENT

**DESIGN PROFESSIONAL IN GENERAL RESPONSIBLE CHARGE STATEMENT:**  
THE POT IDENTIFIED IN THESE CONSTRUCTION DOCUMENTS IS COMPLIANT WITH THE CURRENT APPLICABLE CALIFORNIA BUILDING CODE ACCESSIBILITY PROVISIONS FOR PATH OF TRAVEL REQUIREMENTS FOR ALTERATIONS, ADDITIONS AND STRUCTURAL REPAIRS. AS PART OF THE DESIGN OF THIS PROJECT, THE POT WAS EXAMINED AND ANY ELEMENTS, COMPONENTS OR PORTIONS OF THE POT THAT WERE DETERMINED TO BE NONCOMPLIANT 1) HAVE BEEN IDENTIFIED AND 2) THE CORRECTIVE WORK NECESSARY TO BRING THEM INTO COMPLIANCE HAS BEEN INCLUDED WITHIN THE SCOPE OF THIS PROJECT'S WORK THROUGH DETAILS, DRAWINGS AND SPECIFICATIONS INCORPORATED INTO THESE CONSTRUCTION DOCUMENTS. ANY NONCOMPLIANT ELEMENTS, COMPONENTS OR PORTIONS OF THE POT THAT WILL NOT BE CORRECTED BY THIS PROJECT BASED ON VALUATION THRESHOLD LIMITATIONS OR A FINDING OF UNREASONABLE HARDSHIP ARE SO INDICATED IN THESE CONSTRUCTION DOCUMENTS. DURING CONSTRUCTION, IF POT ITEMS WITHIN THE SCOPE OF THE PROJECT REPRESENTED AS CODE COMPLIANT ARE FOUND TO BE NONCONFORMING BEYOND REASONABLE CONSTRUCTION TOLERANCES, THEY SHALL BE BROUGHT INTO COMPLIANT WITH THE CBC AS A PART OF THIS PROJECT BY MEANS OF A CONSTRUCTION CHANGE DOCUMENT.

IDENTIFICATION STAMP  
DIV. OF THE STATE ARCHITECT  
APP: 03-121846 INC.  
REVIEWED FOR  
SS  FLS  ACS   
DATE: 11/05/2021

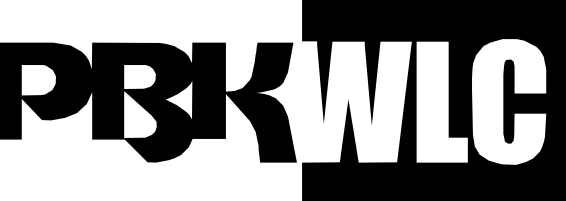

ACCESSIBILITY KEYED NOTES

#	Description
00.01	(E) GATE PER AF 03-117246
00.02	(E) "TOW-AWAY" SIGNAGE - AF 03-117246. SIGN TO MEET CURRENT CODE REQUIREMENTS PER DETAIL SA-102. PROVIDE IN SIGN AS REQUIRED
00.03	RELOCATED HI-LOW DRINKING FOUNTAIN
26.01	TWO-WAY COMMUNICATION WALKIE TALKIE LOCATION

ACCESSIBILITY LEGEND

- NEW PATH OF TRAVEL (POT)
- ACCESSIBLE PATH OF TRAVEL AS INDICATED ON PLAN IS A BARRIER FREE ACCESS ROUTE WITHOUT ANY ABRUPT LEVEL CHANGES EXCEEDING 1/2" IF BEVELED AT 1:2 MAX SLOPE, OR VERTICAL LEVEL CHANGES NOT EXCEEDING 1/4" MAX. AND AT LEAST 48" IN WIDTH. SURFACE IS STABLE, FIRM AND SLIP RESISTANT. CROSS SLOPE DOES NOT EXCEED 2% AND SLOPE IN THE DIRECTION OF TRAVEL IS LESS THAN 5%, UNLESS OTHERWISE INDICATED. ACCESSIBLE PATH OF TRAVEL SHALL BE MAINTAINED FREE OF OVERHANGING OBSTRUCTIONS TO 80" MINIMUM, AND PROTRUDING OBJECTS GREATER THAN 4" PROJECTION FROM WALL AND ABOVE 27" AND LESS THAN 80" ARCHITECT SHALL VERIFY THAT THERE ARE NO BARRIERS IN THE PATH OF TRAVEL. SEE ALSO "DESIGN PROFESSIONAL STATEMENT" ON THIS SHEET.
- (E) POT PER AF 03-118916
- ▨ (E) BUILDINGS
- ▨ ASPHALT CONC. PAVING
- ▨ SAFE DISPERSAL AREA PER CBC 1028.5
- ASSUMED PROPERTY LINE
- - - - - PROPERTY LINE

PARKING CALCULATION

(E) PARKING LOT NO. 1 (AF 03-105999, 03-117246):	PROVIDED	REQUIRED
ACCESSIBLE STALLS	1	1
STANDARD PARKING STALLS	10	
(E) PARKING LOT NO. 2 (AF 03-105999, 03-117246):		
ACCESSIBLE STALLS	2	2
STANDARD PARKING STALLS	26	
<b>TOTAL PARKING STALLS ON SITE</b>	<b>39</b>	

DSA CERTIFICATION LIST

- THE FOLLOWING PROJECT: **AF 03 - 117246** CLOSED WITH DSA CERTIFICATION ON 3/4/2020
- THE FOLLOWING PROJECT: **AF 03 - 118902** CLOSED WITH DSA CERTIFICATION ON 10/06/2020
- THE FOLLOWING PROJECT: **AF 03 - 118916** CLOSED WITH DSA CERTIFICATION ON 6/10/2019
- THE FOLLOWING PROJECT: **AF 03 - 118961** CLOSED WITH DSA CERTIFICATION ON 08/07/2019
- THE FOLLOWING PROJECT: **AF 03 - 117282** CLOSED WITH DSA CERTIFICATION ON 10/30/2017
- THE FOLLOWING PROJECT: **AF 03 - 114492** CLOSED WITH DSA CERTIFICATION ON 03/05/2014
- THE FOLLOWING PROJECT: **AF 03 - 112740** CLOSED WITH DSA CERTIFICATION ON 08/19/2011
- THE FOLLOWING PROJECT: **AF 03 - 105999** CLOSED WITH DSA CERTIFICATION ON 9/7/2010

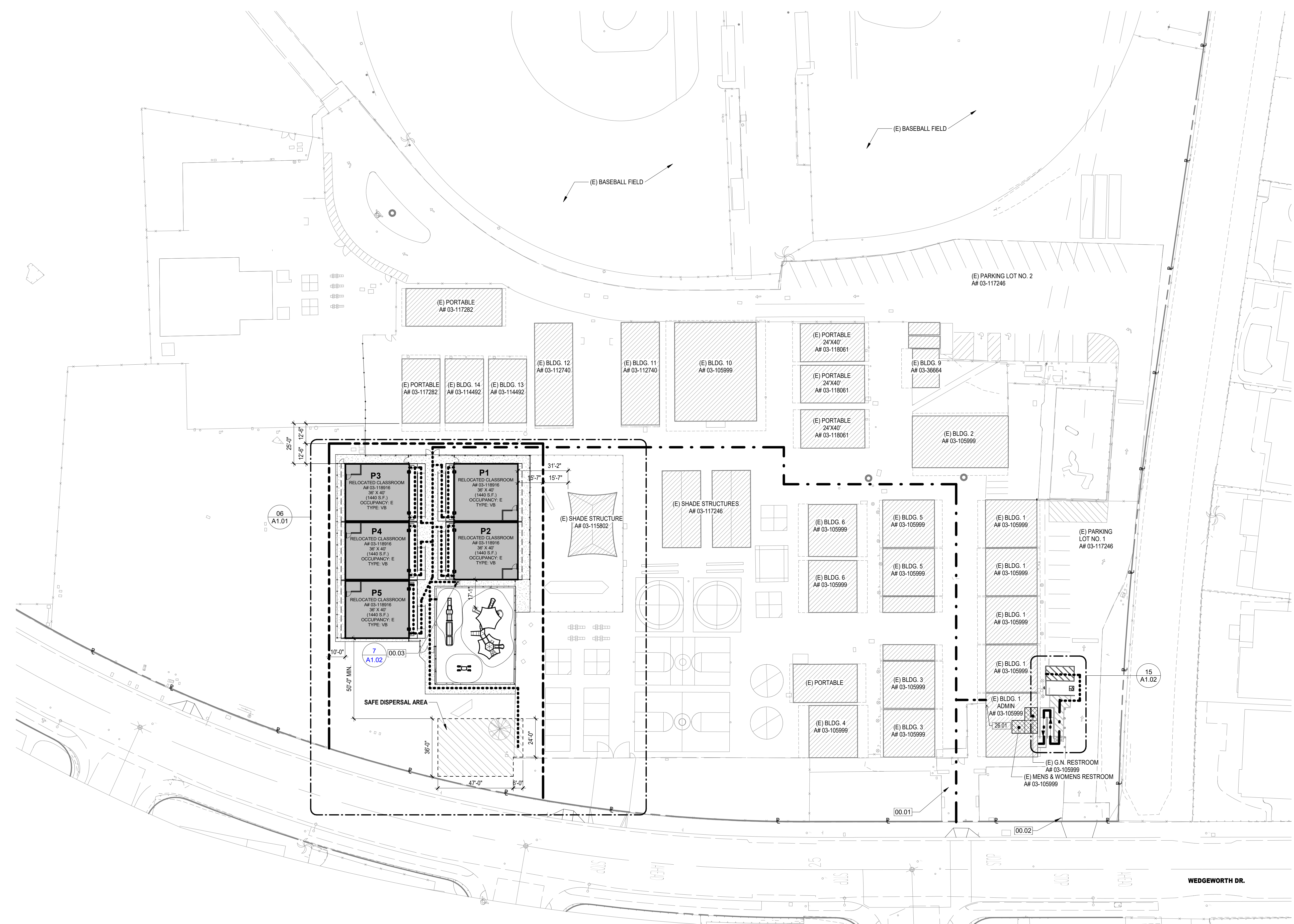

Wedge worth ES Portable Relocation

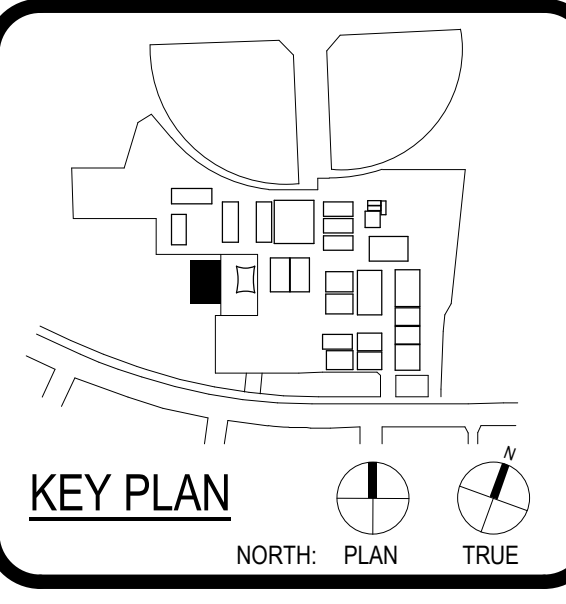

CLIENT: HACIENDA LA PUENTE USD  
DATE: 10/12/2021  
PROJECT NUMBER: P2127100AR

No.	Description	Date

CONSTRUCTION DOCUMENTS  
BUILDING NUMBER

ACCESSIBILITY SITE PLAN