

SECURITY ALARM SYSTEM SPECIFIC NOTES:

- 1 EXISTING SECURITY SYSTEM CONTROL PANEL. PROVIDE ADDITIONAL ZONE EXPANDERS, POWER SUPPLY, BATTERY BACKUP, TERMINAL BLOCKS, ETCETERA AS REQUIRED TO ACCOMMODATE THE NEW DEVICES IN THIS SCOPE.
- 2 MULTI-PAIR BACKBONE CABLE PER MANUFACTURER'S RECOMMENDATIONS. PROVIDE OSP-RATED WHEN INSTALLED IN UNDERGROUND CONDUIT BETWEEN BUILDINGS.
- 3 EXISTING WALL MOUNT LOCKABLE TERMINAL CABINET COMPLETE WITH TERMINAL STRIPS, POWER SUPPLY, PORTS, ETCETERA FOR A COMPLETE AND FULLY FUNCTIONAL SYSTEM. ALL CABLES AND TERMINATIONS SHALL CLEARLY IDENTIFY THE DEVICE LOCATIONS WITH MACHINE GENERATED LABELS.
- 4 GLASS BREAK DETECTOR PER EXISTING TO REMAIN. RE-CABLE TO EXISTING LOCATIONS.
- 5 RECESSED DOOR CONTACTS EXISTING TO REMAIN. RE-CABLE TO EXISTING LOCATIONS.
- 6 PROVIDE SECURITY SYSTEM DEVICE CABLING PER MANUFACTURER'S SPECIFICATIONS. INSTALL IN CONDUIT WHEN PLACED IN OPEN CEILINGS AND INACCESSIBLE CEILINGS. CABLE SHALL BE RATED FOR THE ENVIRONMENT IN WHICH IT IS INSTALLED.

SECURITY SYSTEM GENERAL NOTES:

1. REFERENCE SPECIFICATIONS FOR ADDITIONAL INFORMATION AND REQUIREMENTS.
2. DRAWINGS AND LAYOUTS ARE PRIMARILY DIAGRAMMATIC IN NATURE. CONTRACTOR IS RESPONSIBLE FOR FINAL FOOTAGES AND EXACT LOCATIONS.
3. CONTRACTOR SHALL COORDINATE DIRECTLY WITH THE DISTRICT FOR ALL ZONING AND DEVICE ADDRESSING REQUIREMENTS.

SECURITY ALARM SYSTEM BLOCK DIAGRAM
 SCALE: NTS

3

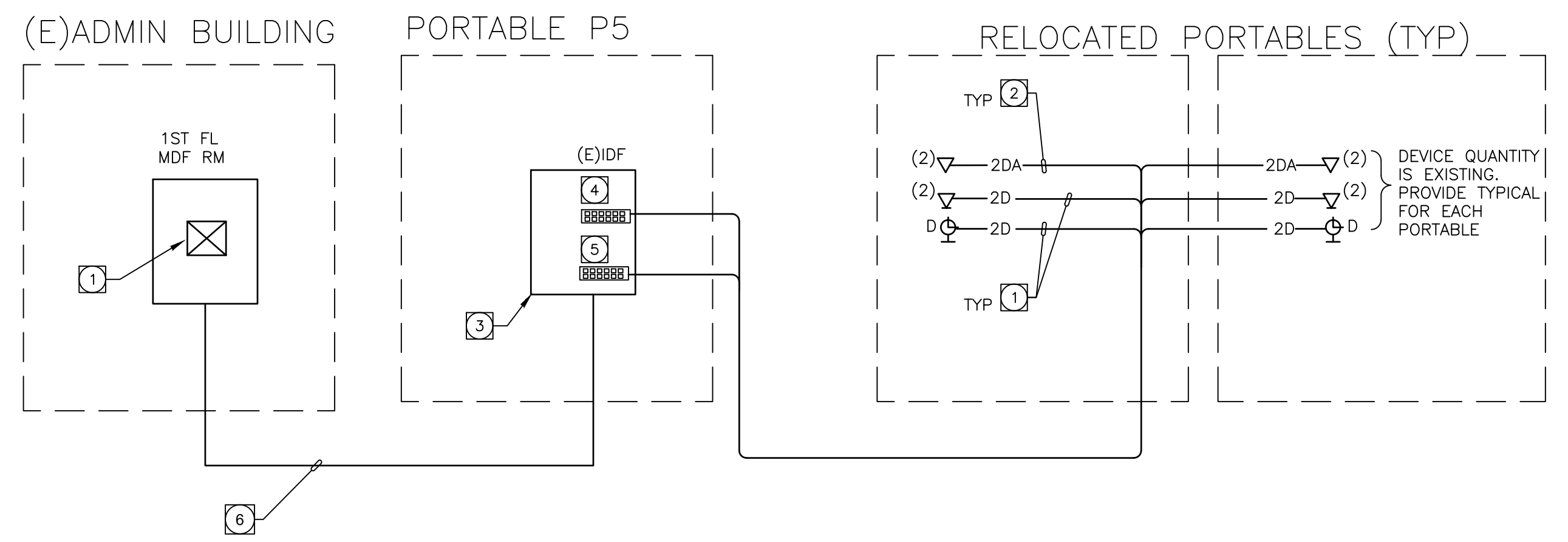

LAN / VOIP SYSTEM BLOCK DIAGRAM KEY NOTES:

- 1 CATEGORY-6 UTP 4-PAIR CABLE(S). CABLE QUANTITIES AT EACH DEVICE PER PLAN DRAWINGS, FACEPLATE DETAILS AND CABLE SCHEDULE. TERMINATE ON CAT-6 OUTLET(S) AT DEVICE LOCATION AND ON CAT-6 PATCH PANEL(S) AT IDF LOCATION.
- 2 CATEGORY-6A UTP 4-PAIR CABLE(S). CABLE QUANTITIES AT EACH DEVICE PER PLAN DRAWINGS, FACEPLATE DETAILS AND CABLE SCHEDULE. TERMINATE ON CAT-6A OUTLET(S) AT DEVICE LOCATION AND ON CAT-6A PATCH PANEL(S) AT IDF LOCATION.
- 3 EXISTING IDF RACK. MODIFY AS REQUIRED TO ACCOMMODATE THE ADDITION OF NEW CABLES.
- 4 RACK MOUNT CATEGORY-6 PATCH PANEL. INSTALL IN IDF/MDF RACK/CABINET. QUANTITY AS REQUIRED TO TERMINATE ALL CAT-6 CABLES ON THIS PROJECT. SEE SPECIFICATIONS FOR MORE INFORMATION. PROVIDE MACHINE GENERATED LABELS.
- 5 RACK MOUNT CATEGORY-6A PATCH PANEL. INSTALL IN IDF/MDF RACK/CABINET. TERMINATE ALL CAT-6A CABLES IN CAT-6A PATCH PANELS. QUANTITY AS REQUIRED TO TERMINATE ALL CAT-6A CABLES. SEE SPECIFICATIONS FOR MORE INFORMATION. PROVIDE MACHINE GENERATED LABELS.
- 6 CONTRACTOR SHALL FURNISH AND INSTALL NEW FIBER CONNECTION BACK TO EXISTING MDF TO IDF CABINET. FIBER SHALL MATCH EXISTING. TERMINATE FIBER IN MDF AND IDF USING EXISTING PATCH PANELS. FIBER SHALL BE TESTED PRIOR TO TURN OVER.

LAN/VOIP CABLE SCHEDULE

DESIGNATOR	CABLE QUANTITY AND TYPE
2D	(2) CATEGORY-6 UTP INDOOR/OUTDOOR 4-PAIR
2DA	(2) CATEGORY-6A UTP INDOOR/OUTDOOR 4-PAIR

LAN/VOIP SYSTEM GENERAL NOTES:

1. REFERENCE SPECIFICATIONS FOR ADDITIONAL INFORMATION AND REQUIREMENTS.
2. DRAWINGS AND LAYOUTS ARE PRIMARILY DIAGRAMMATIC IN NATURE. CONTRACTOR IS RESPONSIBLE FOR FINAL FOOTAGES AND EXACT LOCATIONS.

LAN, VOIP, AND IP CLOCK SYSTEMS BLOCK DIAGRAM
 SCALE: NTS

1

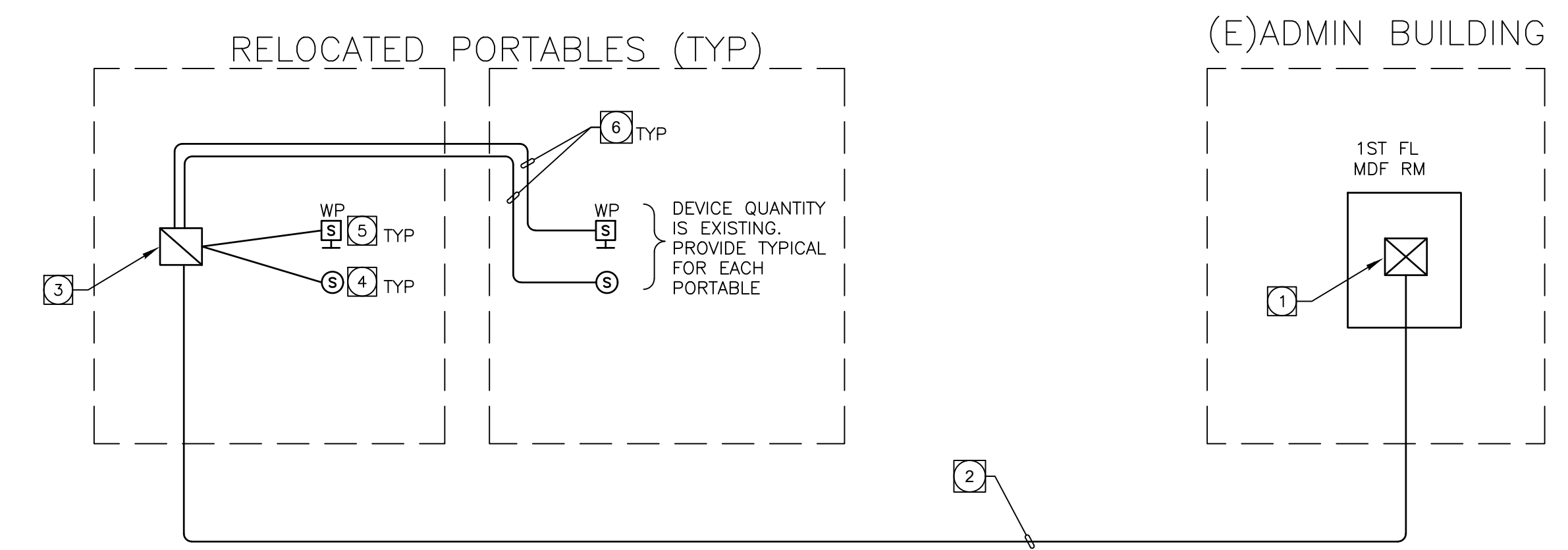

PUBLIC ADDRESS SYSTEM DIAGRAM KEY NOTES:

- 1 MODIFY EXISTING PUBLIC ADDRESS SYSTEM HEAD END EQUIPMENT AS REQUIRED TO ACCOMMODATE THE SCOPE OF THIS PROJECT.
- 2 MULTI-PAIR BACKBONE CABLE PER MANUFACTURER'S RECOMMENDATIONS. PROVIDE OSP-RATED WHEN INSTALLED IN UNDERGROUND CONDUIT BETWEEN BUILDINGS.
- 3 EXISTING WALL MOUNT TERMINAL CABINET COMPLETE WITH TERMINAL STRIPS, AMPLIFIER, CONNECTION JUMPERS, ETCETERA FOR A COMPLETE AND FULLY FUNCTIONAL SYSTEM. ALL CABLES AND TERMINATIONS SHALL CLEARLY IDENTIFY THE DEVICE LOCATIONS WITH MACHINE GENERATED LABELS.
- 4 FLUSH CEILING MOUNT SPEAKER WITH BACK BOX AND BAFFLE PER SPECIFICATIONS. QUANTITY AND LOCATIONS PER PLAN DRAWINGS.
- 5 SURFACE WALL MOUNT EXTERIOR WEATHER PROOF PUBLIC ADDRESS SPEAKER WITH BACK BOX AND BAFFLE, PER SPECIFICATIONS. PAINT BAFFLE TO MATCH SURROUNDING SURFACES. QUANTITY AND LOCATIONS PER PLAN DRAWINGS.
- 6 CABLE PER MANUFACTURER'S RECOMMENDATIONS. CABLE SHALL BE RATED FOR THE ENVIRONMENT IN WHICH IT IS INSTALLED, PER CODE.

PUBLIC ADDRESS SYSTEM GENERAL NOTES:

1. REFERENCE SPECIFICATIONS FOR ADDITIONAL INFORMATION AND REQUIREMENTS.
2. DRAWINGS AND LAYOUTS ARE PRIMARILY DIAGRAMMATIC IN NATURE. CONTRACTOR IS RESPONSIBLE FOR FINAL FOOTAGES AND EXACT LOCATIONS.
3. CONTRACTOR SHALL SET AND ADJUST ALL SPEAKER VOLUME LEVELS TO THE DISTRICT'S SATISFACTION.

PUBLIC ADDRESS SYSTEM BLOCK DIAGRAM
 SCALE: NTS

2

Wedge worth ES Portable Relocation

16949 WEDGE WORTH DR.
 HACIENDA HEIGHTS, CA 91745
 CONSTRUCTION DOCUMENTS
 DSA APPL. NO.: 03-121846 DSA FILE NO.: 19-38

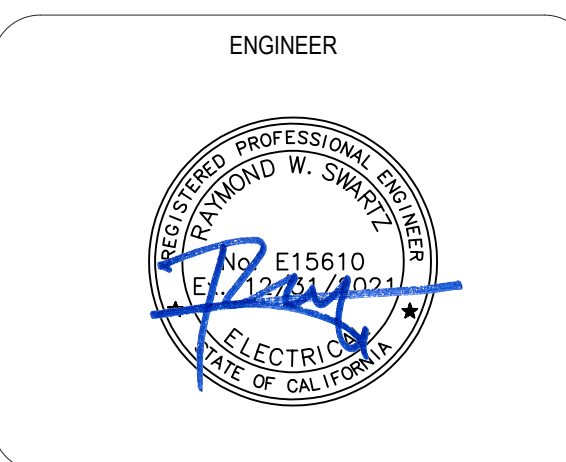
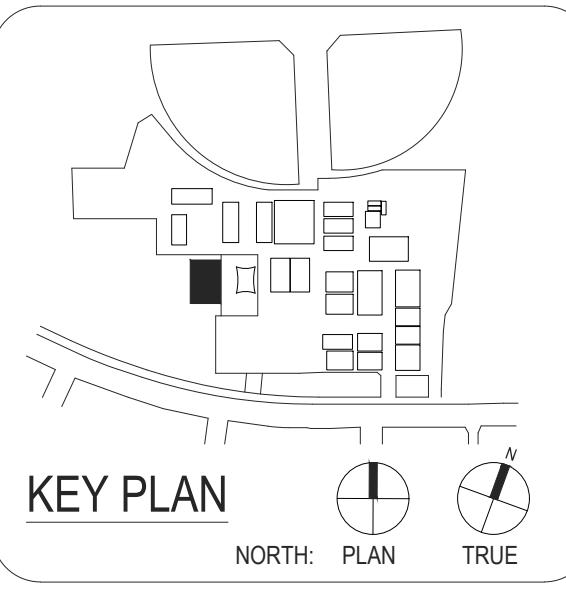

CLIENT	HACIENDA LA PUENTE USD
DATE	10/12/2021
PROJECT NUMBER	#####

No.	Description	Date

CONSTRUCTION DOCUMENTS

TECHNOLOGY DIAGRAMS