

PLAN NOTES:

- 1 EXISTING ELECTRICAL EQUIPMENT TO REMAIN PROTECTED IN PLACE.
- 2 EXISTING POWER PULLBOX.
- 3 FIRE ALARM WEATHERPROOF EXTERIOR SPEAKER. REFER TO FIRE ALARM DRAWINGS FOR ADDITIONAL INFORMATION.
- 4 EXISTING (1)3" (3)2" COMMUNICATIONS DUCT BANK TO BE PROTECTED IN PLACE. PROVIDE ADDITIONAL CONDUIT BANKS AS REQUIRED.
- 5 PROVIDE THE FOLLOWING CONDUITS WITH CONDUCTORS:
2-3" (DATA-TEL-CLOCK), 2" (SECURITY-PA)
- 6 INTERCEPT EXISTING CONDUIT AND CABLE FROM EXISTING PULLBOX. PROVIDE NEW CABLING BACK TO CAMPUS MDF IN ADMIN. MATCH EXISTING CABLING FOR COMPLETE OPERABLE SYSTEM.
- 7 PROVIDE THE FOLLOWING CONDUITS WITH CONDUCTORS:
2-2" (DATA-TEL-CLOCK)
- 8 MODIFY EXISTING LAN NETWORK, PUBLIC ADDRESS, SECURITY, FIRE ALARM SYSTEMS' HEADEND EQUIPMENT AS NECESSARY IN ORDER TO ACCOMMODATE THE RELOCATED BUILDINGS.
- 9 INTERCEPT EXISTING CONDUIT AND FEEDERS FROM EXISTING PULLBOX. PROVIDE NEW CONDUIT AND FEEDERS EXTENDED TO RELOCATED RELOCATABLE LOCATION.
- 10 FIRE ALARM ANNUNCIATOR AND REMOTE MICROPHONE. PLACE NEXT TO ADMIN DESK. VERIFY EXACT LOCATION IN FIELD.
- 11 12" PEDESTRIAN POLE TO BE CONTROLLED BY TIMELOCK/PHOTOCELL. PART NUMBER MSA-FD2-LED-E1-RW-FINISH-8030-MS/BIM-L20.

SITE PLAN GENERAL NOTES:

1. CONTRACTOR SHALL EXERCISE EXTREME CAUTION IN EXCAVATING AND TRENCHING ON THIS SITE TO AVOID EXISTING DUCTS, PIPING OR CONDUITS, ETC., AND TO PREVENT HAZARDS TO PERSONNEL AND/OR DAMAGE TO EXISTING UNDERGROUND UTILITIES OR STRUCTURES WHETHER OR NOT SHOWN AND INSTALLED BY ANY OTHER CONTRACTS. THE ENGINEER IS NOT RESPONSIBLE FOR THE LOCATION OF UNDERGROUND UTILITIES OR STRUCTURES WHETHER OR NOT SHOWN OR DETAILED AND INSTALLED BY ANY OTHER CONTRACTS. THE CONTRACTOR SHALL IMMEDIATELY NOTIFY THE ENGINEER SHOULD SUCH UNIDENTIFIED CONDITIONS BE DISCOVERED. THESE DRAWINGS AND SPECIFICATIONS DO NOT INCLUDE THE NECESSARY ELEMENTS FOR CONSTRUCTION SAFETY.
2. CALL UNDERGROUND SERVICE ALERT (USA) AT 1 (800) 422-4133 OR APPLICABLE STATE AND LOCAL DIG SAFE OR UNDERGROUND ALERT HOTLINES PRIOR TO CONSTRUCTION START.
3. MINIMUM CONDUIT SIZE SHALL BE 3/4" - U.O.N.
4. MINIMUM CONDUCTOR SIZE SHALL BE #10 AWG. - U.O.N.
5. ALL SITE BRANCH CIRCUITS SHALL INCLUDE AN EQUIPMENT GROUND CONDUCTOR THAT, AT MINIMUM, MATCHES THE SIZE OF THE ASSOCIATED BRANCH CIRCUIT CONDUCTOR. WHERE MULTIPLE BRANCH CIRCUITS ARE ROUTED/GROUPED TOGETHER, THE EQUIPMENT GROUNDING CONDUCTOR SHALL MATCH THE SIZE OF THE LARGEST BRANCH CIRCUIT CONDUCTOR IN THE GROUP.
6. ALL ELECTRICAL EQUIPMENT MOUNTED OUTDOORS SHALL BE WEATHERPROOF (NEMA #3R).
7. ALL CONDUIT ONLY SHALL BE PROVIDED WITH A NYLON PULL STRING.
8. SEE ARCHITECTURAL/LANDSCAPE ARCHITECTURAL PLANS FOR EXACT LOCATIONS OF FIXTURES, PULLBOXES, MANHOLES, OTHER ELECTRICAL DEVICES, ETC. COORDINATE ALL UNDERGROUND STRUCTURES AND CONDUIT ROUTING WITH LANDSCAPE ARCHITECT PRIOR TO ROUGH-IN TO ENSURE THAT SUCH ITEMS ARE NOT PLACED IN CRITICAL LANDSCAPE PLANTING/HARDSCAPE AREAS.
9. UNLESS SPECIFICALLY SHOWN AS (E), (R), (EP), (D), EXISTING OR NON-BOLD, ALL ELECTRICAL DEVICES SHOWN ARE NEW.
10. SAWCUT, TRENCH AND EXCAVATE AS REQUIRED TO INSTALL CONDUITS AND FEEDERS AS INDICATED, BACKFILL, TAMP AND RESURFACE TO ORIGINAL CONDITION. PATH TO PEDESTRIAN AREAS SHALL COMPLY WITH 11B-302.1 AND 11B-303. REFER TO DETAIL 9, SHEET E4.01.

SITE UTILITY PLAN CONSTRUCTION NOTES:

- THESE NOTES ESTABLISH MINIMUM QUALITY LEVELS AND COORDINATION REQUIREMENTS. RESPECTIVE UTILITY COMPANY PLANS AND REQUIREMENTS TAKE PRECEDENCE OVER THESE NOTES WITH REGARD TO RESPECTIVE UTILITY COMPANY CONDUIT AND UNDERGROUND STRUCTURE SYSTEMS.
1. CALL UNDERGROUND SERVICE ALERT (USA) AT (800) 422-4133 OR APPLICABLE STATE AND LOCAL DIG SAFE OR UNDERGROUND ALERT HOTLINES PRIOR TO CONSTRUCTION START.
 2. COORDINATE ALL UNDERGROUND STRUCTURES AND CONDUIT ROUTING WITH LANDSCAPE ARCHITECT PRIOR TO ROUGH-IN TO ENSURE THAT SUCH ITEMS ARE NOT PLACED IN CRITICAL LANDSCAPE PLANTING/HARDSCAPE AREAS.
 3. VAULTS, MAINTENANCE HOLES (MH's), FORMERLY KNOWN AS MANHOLES, AND CONDUITS SHALL MAINTAIN A MINIMUM COVER OF 24" BELOW FINAL SURFACE AT ALL CONDITIONS. INCLUDE ALL COSTS IN BASE BID TO MEET UTILITY COMPANY REQUIREMENTS WHICH MAY REQUIRE GREATER MINIMUM CONDUIT DEPTHS.
 4. VAULTS, MH's AND PULLBOXES (PB's) SHALL BE EQUIPPED WITH KNOCKOUT PANELS OR PRE-CAST INDIVIDUAL CONDUIT OPENINGS. CONDUITS SHALL ONLY ENTER AND EXIT ON END/SHORT WALLS. CONDUITS MAY EXIT ON SIDE/LONG WALLS, CEILINGS OR FLOORS UNLESS OTHERWISE NOTED.
 5. CUT DUCTS FLUSH WITH INTERIOR VAULT/MH/PB WALL.
 6. GROUT AROUND DUCT ENTRANCES ON VAULT/MH/PB WALLS.
 7. SLURRY BACKFILL AROUND DUCTS WITHIN 5 FEET OF VAULT/MH/PB TO PREVENT SHEARING.
 8. CONDUITS PASSING UNDER THE BUILDING PERIMETER SHALL BE ENCASED IN LIGHTWEIGHT CONCRETE OR WATER-IMPERVIOUS CLAY TO PREVENT WATER INFILTRATION. SEE ELECTRICAL SPECIFICATIONS FOR ADDITIONAL INFORMATION.
 9. CONDUIT BEND RADIUS FOR BUILDING ENTRANCES AND AT POLES SHALL BE A MINIMUM OF 24" FOR CONDUITS WITH LESS THAN 2" INTERNAL DIAMETER AND A MINIMUM OF 48" FOR CONDUITS WITH MORE THAN 2" INTERNAL DIAMETER.
 10. PREFERRED CONDUIT SWEEP RADIUS BETWEEN VAULTS IS 25 FEET. UNDER NO CIRCUMSTANCES SHALL THE CONDUIT SWEEP RADIUS BE LESS THAN 12.5 FEET. MAXIMUM OF 90 DEGREES PER SWEEP AND LIMITED TO NO MORE THAN (2) 90 DEGREE SWEEPS BETWEEN VAULTS.
 11. VAULTS/MH's/PB's ARE TO BE EQUIPPED WITH RACKING, GROUNDING LUGS, AND BOLT-DOWN LIDS UNLESS OTHERWISE NOTED.
 12. VAULTS AND MH's TO BE EQUIPPED WITH ROUND COVERS, EXTENSION RINGS AS REQUIRED, LADDERS AND (3) SEGMENTS OF 6 FOOT HIGH CABLE RACKING PER EACH LONG WALL.
 13. LABEL ALL NON-UTILITY COMMUNICATION VAULT/MH/PB COVERS WITH "COMMUNICATIONS" UNLESS OTHERWISE NOTED ON PLANS.
 14. COORDINATE FINAL VAULT/MH/PB OPENING HEIGHT WITH G.C. PRIOR TO ROUGH-IN TO ENSURE FINAL GRADE DOES NOT SLOPE INTO VAULT/MH/PB OPENING.
 15. CONTRACTOR TO PROVIDE A MINIMUM OF 8" DEEP COMPACTED 1/2" DIAMETER GRAVEL, UNDER ALL VAULTS, MH's OR PB's TO ENSURE UNIFORM DISTRIBUTION OF SOIL PRESSURE ON THE FLOOR AND BE ABLE TO DISSIPATE WATER OUT OF THE VAULT, MH OR PB.
 16. ALL VAULTS/MH's/PB's WITHOUT GROUNDING LUGS SHALL HAVE AN 8' x 3/4" COPPER GROUND ROD DRIVEN THRU THE FLOOR TO ALLOW GROUNDING OF ITEMS WITHIN.
 17. ALL VAULTS/MH's/PB's SHALL BE PROVIDED WITH TRAFFIC RATED COVERS WHEN LOCATED IN PAVED AREAS UTILIZED FOR VEHICLE TRAFFIC.
 18. IF THE WATER OR MOISTURE BARRIER ON OR NEAR THE FOUNDATION OF A BUILDING IS DISTURBED IN ANY MANNER BY EXCAVATION OR OTHER CONSTRUCTION WORK, THE MOISTURE BARRIER MUST BE REPAIRED FOLLOWING THE RECOMMENDATIONS OF THE MANUFACTURER OF THE ORIGINAL BARRIER PRODUCT.
 19. THE CONTRACTOR SHALL INCLUDE IN BASE BID ALL COSTS TO COMPLY WITH ALL REQUIREMENTS FOR CONFINED SPACE ENTRY PER THE OSHA REQUIREMENTS 29 CFR-1910.146, 29 CFR-1910.268, ETC. DURING ANY CONFINED SPACE ENTRY.
 20. ANY DUCTS LEAVING A VAULT, MH OR PB ROUTED INTO A FACILITY SHALL BE PLUGGED AT EACH END USING REMOVABLE MECHANICAL PLUGS DESIGNED TO PREVENT WATER AND GAS FROM ENTERING THE FACILITY.
 21. SEE ELECTRICAL SPECIFICATIONS AND PLAN DETAILS FOR ADDITIONAL REQUIREMENTS REGARDING UNDERGROUND CONDUITS AND IN-GRADE VAULT/MH/PB/JUNCTION BOXES.

IDENTIFICATION STAMP
DIV. OF THE STATE ARCHITECT
APP: 03-121846 INC.
REVIEWED FOR
SS FLS ACS
DATE: 11/05/2021



ARCHITECT
SOUTHERN CALIFORNIA
8163 Rochester Avenue, Suite 100
Rancho Cucamonga
California 91730-0729
909-987-5959 P



11870 Pierce Street, Suite 160
Riverside, California 92505
951-299-4160 www.tkisc.com
Project Leader - Nikolas Bruno
tkisc Job #: 2021-0458

Wedge worth ES Portable Relocation

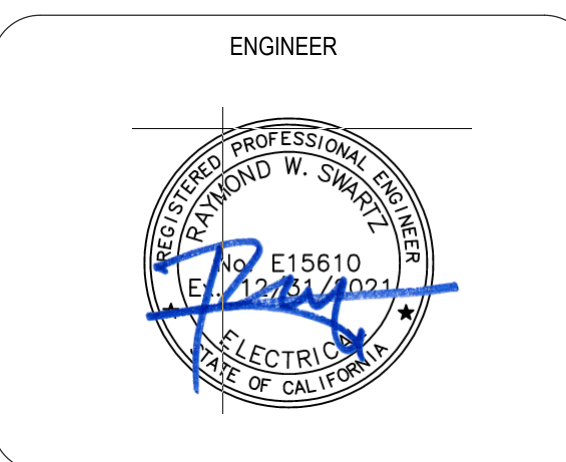
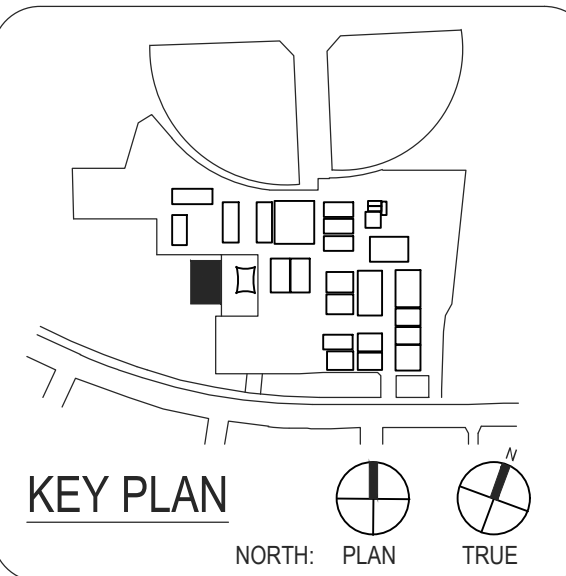

CLIENT HACIENDA LA PUENTE USD		
DATE 10/12/2021	PROJECT NUMBER #####	
DRAWING HISTORY		
No.	Description	Date

CONSTRUCTION DOCUMENTS

ELECTRICAL SITE PLAN

E1.01

CHECKED BY:
Checker
DRAWN BY:
Author

01 ELECTRICAL SITE PLAN
1" = 30'-0"