

**HATCH LEGEND:**

- [Hatched Box] = RELOCATED PORTABLE BUILDING
- [Dotted Box] = EXISTING LANDSCAPE
- [Hexagonal Box] = EXISTING RUBBERIZED SURFACE

**UTILITY LINETYPE LEGEND:**

- SD (E) STORM DRAIN
- WD (E) DOMESTIC WATER
- SS (E) SANITARY SEWER
- GS (E) GAS
- EC (E) ELECTRICAL/POWER
- CC (E) COMMUNICATIONS

**CONSTRUCTION NOTES:**

(A) CONSTRUCT RAMP PER MODULAR BUILDING DETAILS.

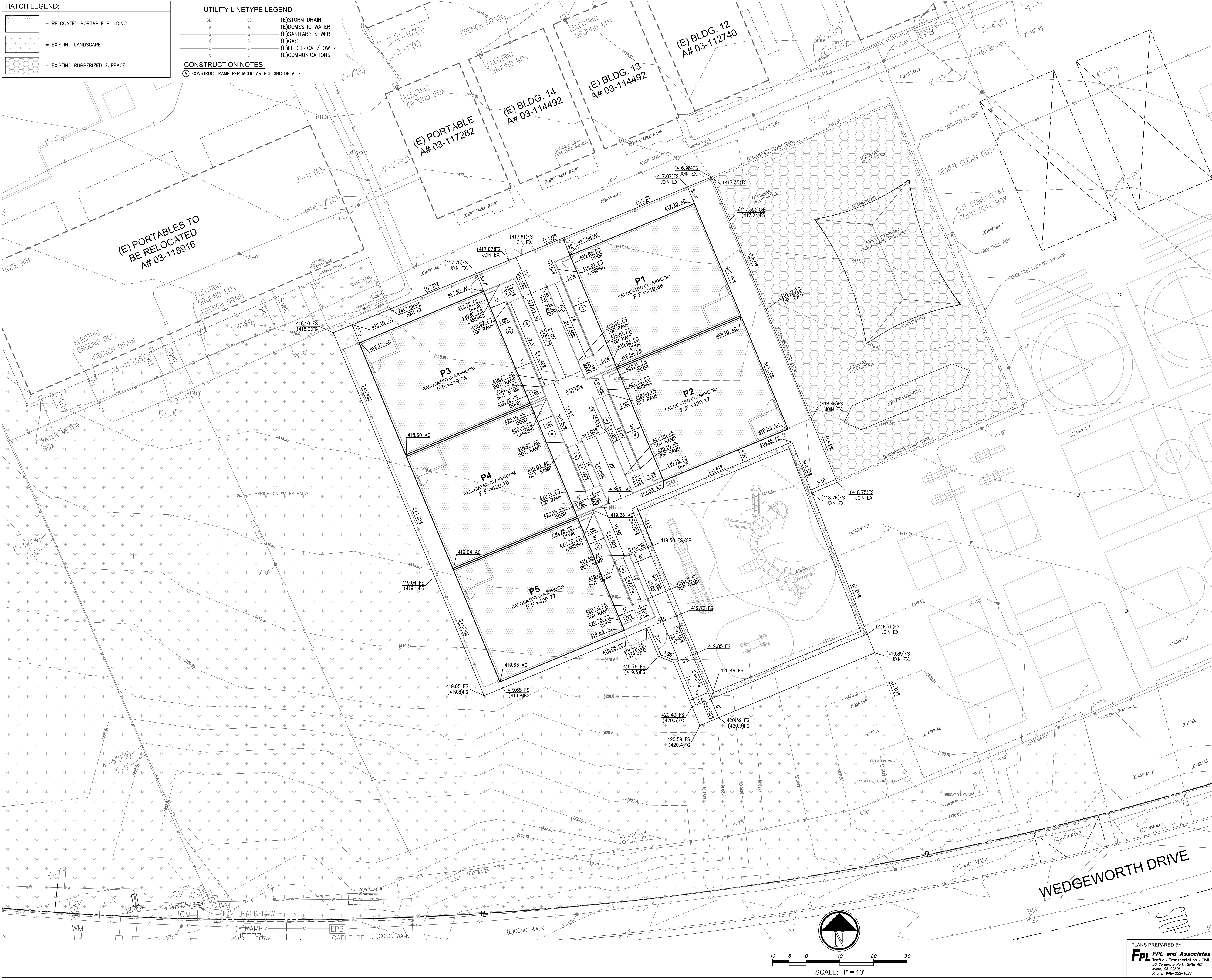

IDENTIFICATION STAMP  
 DIV. OF THE STATE ARCHITECT  
 APP: 03-121846 INC.  
 REVIEWED FOR  
 SS  FLS  ACS   
 DATE: 11/05/2021



ARCHITECT: PBK Architects, Inc.  
 SOUTHERN CALIFORNIA  
 8163 Rochester Avenue, Suite 100  
 Rancho Cucamonga  
 California 91730-0725  
 909-987-0909 P

**Wedgeworth ES Portable Relocation**

16949 WEDGEWORTH DR.  
 HACIENDA HEIGHTS, CA 91745  
 CONSTRUCTION DOCUMENTS  
 DSA APPL. NO.: 03-121846 DSA FILE NO.: 18-38

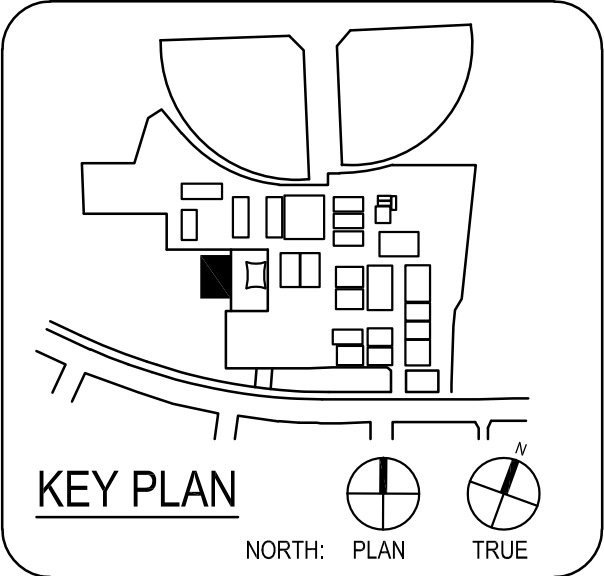

CLIENT: HACIENDA LA PUENTE USD  
 DATE: 10/12/2021  
 PROJECT NUMBER: P2127100AR

No.	Description	Date

CONSTRUCTION DOCUMENTS

**PORTABLE GRADING PLAN**

PLANS PREPARED BY:  
**FPL FPL and Associates**  
 Traffic - Transportation - Civil  
 30 Corporate Park, Suite 401  
 Irvine, CA 92606  
 Phone: 949-252-1888

**C1.02**

Plot Date: 10/12/2021 9:06:33 AM Login: Ron Connelly S:\Jobs\2177 - PBK\2177 - Wedgeworth ES\Civil\Relocated Portables Wedgeworth ES Relocated Portables C1.02 Portable Grading Plan.dwg Last Save By: ron.connelly