

ENLARGED SITE PLAN  
 A1.01  
 FOR BLUEBEAM LABELING ONLY  
 File Path: C:\Users\skelaman\Documents\Wedgeworth ES Portable Relocation\_A21\_Central.april.kaiman.rvt  
 CHECKED BY: [Blank]  
 DRAWN BY: [Blank]  
 Plot Stamp: 10/12/2021 4:57:23 PM

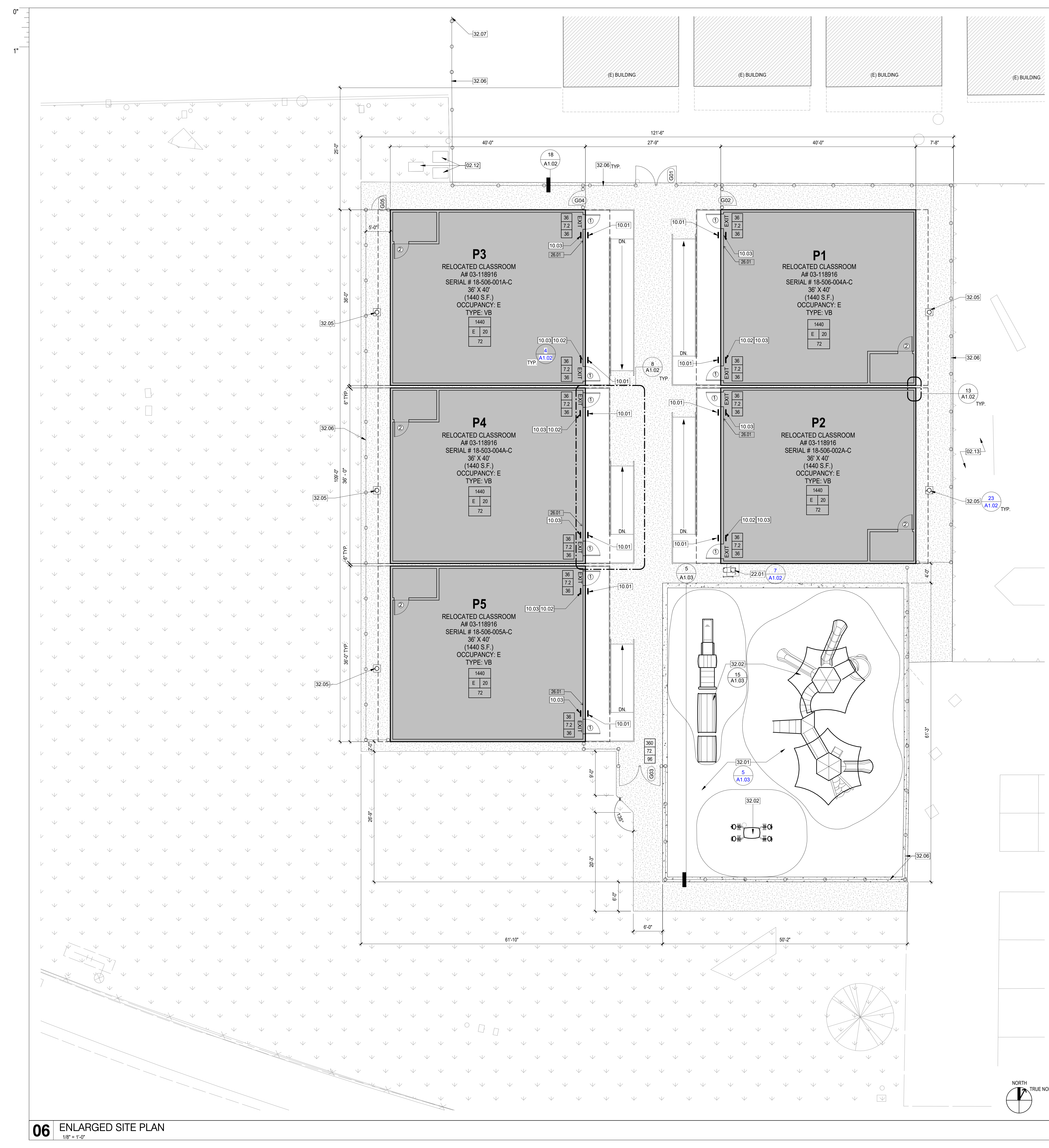

**GENERAL NOTES**

- PROVIDE TOUCH UP PAINT TO BUILDINGS, TRIM, AND DOORS AS REQUIRED.
- ASSISTIVE LISTENING SYSTEMS SHALL BE PROVIDED IN ACCORDANCE WITH CBC SECTION 11B-219 AND SHALL COMPLY WITH CBC SECTION 11B-706. 25% MINIMUM OF RECEIVERS PROVIDED BUT NO FEWER THAN TWO SHALL BE HEARING-AID COMPATIBLE IN ACCORDANCE WITH CBC SECTION 11B-706.3
- IF THE SYSTEM PROVIDED IS LIMITED TO SPECIFIC AREAS OR SEATS, THEN SUCH AREAS OR SEATS SHALL BE WITHIN A 50-FOOT VIEWING DISTANCE OF, AND HAVE A COMPLETE VIEW OF, THE STAGE OR PLAYING AREA CBC SECTION 11B-219.4.

**SITE PLAN LEGEND**

- (N) ASPHALT CONCRETE PAVING, REFER TO CIVIL DRAWINGS
- RELOCATED PORTABLE BUILDING
- PROTECT IN PLACE (E) TURF & IRRIGATION
- ROOM AREA (SQ. FT.)
- OCCUPANT LOAD FACTOR (2019 CBC TABLE 1004.5)
- OCCUPANT LOAD
- OCCUPANCY GROUP
- OCCUPANT LOAD EXITING THRU DOOR OPENING
- REQUIRED EXIT WIDTH (IN INCHES) (2019 CBC 1005.3.2)
- PROVIDED EXIT WIDTH (IN INCHES)
- EXIT EXISTING EMERGENCY EXIT SIGN

**CONSTRUCTION KEYED NOTES**

#	Description
02.12	PROTECT IN PLACE (E) VAULTS
02.13	PROTECT IN PLACE (E) PLAYGROUND
10.01	REMOVE AND REINSTALL ROOM IDENTIFICATION SIGNAGE PER DISTRICT ROOM NUMBER LOCATIONS (SIGNAGE PER A# 03-118916)
10.02	ASSISTIVE LISTENING SYSTEM SIGNAGE
10.03	EXISTING TACTILE EXIT RAMP DOWN SIGN PER A# 03-118916
22.01	RELOCATED H/LOW DRINKING FOUNTAIN
32.01	POURED IN PLACE PLAYGROUND SURFACE
32.02	RELOCATED PLAYGROUND EQUIPMENT
32.05	DRYWELL AT WALL MOUNTED HVAC UNITS
32.06	6" HIGH CHAIN LINK FENCE
32.07	JOIN IN CHAIN LINK FENCE TO END OF (E) CHAIN LINK FENCE
26.01	TWO-WAY COMMUNICATION WALKIE TALKIE LOCATION

**BUILDING CODE ANALYSIS**

BUILDING DESIGNATION	OCCUPANCY CLASSIFICATION	TYPE OF CONSTRUCTION	AUTOMATIC FIRE SPRINKLER SYSTEM	ALLOWABLE BLDG. HT. (FEET)	ALLOWABLE # OF STORIES	ALLOWABLE BLDG. AREA (SQ. FT.)
(5) PORTABLE BUILDINGS (1440 SQ. FT. EACH)	E	VB	NO	40	1	9,500
				ACTUAL BLDG. HT. (FEET)	ACTUAL # OF STORIES	ACTUAL BLDG. AREA (SQ. FT.)
				15	1	8,460 (INCLUDE ROOF OVERHANG)

**GATE SCHEDULE**

GATE #	SIZE (W x H)	MATERIAL	PANIC HARDWARE	HARDWARE GROUP	DETAIL	COMMENTS
G01	8' X 6'	CHAINLINK	YES	GROUP 1	2/A1.02	
G02	4' X 6'	CHAINLINK	NO	-	1/A1.02	SERVICE GATE
G03	8' X 6'	CHAINLINK	YES	GROUP 1	2/A1.02	
G04	4' X 6'	CHAINLINK	NO	-	1/A1.02	SERVICE GATE
G05	4' X 6'	CHAINLINK	NO	-	1/A1.02	SERVICE GATE

**EXISTING DOOR SCHEDULE**

DOOR NO.	DOOR TYPE	DOOR SIZE	QUANTITY	DOOR			FRAMES			REMARKS
				MATERIAL	FINISH	HARDWARE SET NO.	FRAME TYPE	MATERIAL	FINISH	
1	01	3'-0" x 7'-0"	2	HM	PT	B	(F)	S	PT	HARDWARE LOCKABLE FROM THE INSIDE, SEE DOOR NOTE #3
2	02	3'-0" x 7'-0"	1	SC	CLR	D	(F)	S	PT	

**DOOR ABBREVIATIONS**

- HM - HOLLOW METAL
- AL - ALUMINUM
- S - STEEL
- SST - STAINLESS STEEL
- STL - STEEL FRAME, 16ga. FULLY WELDED
- WFF - WINDOW WALL FRAME
- SC - SOLID CORE WOOD
- HC - HOLLOW CORE WOOD
- PT - PAINTED
- CA - CLEAR ANODIZED
- BR - BRONZE ANODIZED
- CLR - CLEAR FINISH

**DOOR NOTES**

- DOORS SHALL COMPLY WITH C.B.C. SECTION 1008.
- CLASSROOMS > 1000 S.F. WILL REQUIRE PANIC HARDWARE THAT COMPLIES WITH C.B.C. SECTION 1008.1.10.
- PER C.B.C. 1008.1.11, PROVIDE LOCKS THAT ALLOW DOORS TO CLASSROOMS AND ANY ROOM WITH AN OCCUPANCY OF FIVE OR MORE PERSONS TO BE LOCKED FROM THE INSIDE. LOCKS SHALL COMPLY WITH C.B.C. SECTION 1008.1.9.

**EXISTING HARDWARE SET SCHEDULE**

B	EXTERIOR DOOR PANIC BAR w/PULL ON EXTERIOR VON DUPRIN 22NL (REQUIRED WHEN OCCUPANT LOAD IS 50 OR MORE)
D	INTERIOR RESTROOM COPPER CREEK 6231-RESTROOM w/ADA LEVER

- EXTERIOR DOOR HARDWARE**
- HINGES: HAGER 4-1/2X4-1/2 BUTTS, BB1279 US260, 1-1/2" PAIR SCREW IN BARREL AND BALL BEARING DESIGN.
  - CLOSER: NORTON 8500DA OR 8500FB SERIES, LCN 1460 DEL SERIES OR EQUAL. (5 LBS. MAX. PRESSURE)
  - WEATHERSTRIPPING: ALL EXTERIOR DOORS SHALL BE WEATHERSTRIPPED WITH PEMKO 299D, ULTRA WS007 OR EQUAL, AT DOOR JAMBS AND HEAD.
  - THRESHOLD SHALL BE PEMKO 271 AV 5" ALUMINUM WITH PEMKO 216 AV ULTRA TH042 DOOR BOTTOM.
  - LOCKDOWN: INTERIOR TEACHERS' MANUAL LOCK FOR CAMPUS LOCK DOWN CRITERIA - REQUIRED FOR STATE-FUNDED SCHOOLS, PER EDUCATION CODE SECTION 17075.50 (AND ALSO CBC 1008.1.11); PROVIDE LOCKS THAT ALLOW DOORS TO CLASSROOMS AND ANY ROOM WITH AN OCCUPANCY OF FIVE OR MORE PERSONS TO BE LOCKED FROM THE INSIDE. LOCKS SHALL COMPLY WITH C.B.C. SECTION 1008.1.9.

IDENTIFICATION STAMP  
 DIV. OF THE STATE ARCHITECT  
 APP: 03-121846 INC.  
 REVIEWED FOR:  
 SS  FLS  ACS   
 DATE: 11/05/2021

**PRKWLC**  
 ARCHITECT  
 SOUTHERN CALIFORNIA PRK Architects, Inc.  
 8163 Rochester Avenue, Suite 100  
 Rancho Cucamonga  
 California 91730-0729  
 909-987-0999 P

**Wedgeworth ES Portable Relocation**

16949 WEDGEWORTH DR.  
 HACIENDA HEIGHTS, CA 91745  
 CONSTRUCTION DOCUMENTS  
 DSA-APPL. NO. 03-121846 DSA-FILE NO. 19-38

HACIENDA LA PUENTE UNIFIED SCHOOL DISTRICT

KEY PLAN  
 NORTH PLAN TRUE

ARCHITECT  
 LICENSED ARCHITECT  
 STATE OF CALIFORNIA  
 No. C-28195

CLIENT: HACIENDA LA PUENTE USD  
 DATE: 10/12/2021 PROJECT NUMBER: P2127100AR

No.	Description	Date

CONSTRUCTION DOCUMENTS  
 BUILDING NUMBER

**ENLARGED SITE PLAN**

**A1.01**